

DESCRIPTION:

SNAPNRACK, ULTRA RAIL MID CLAMP

DRAWN BY:

mwatkins

**SnapNrack™**  
Solar Mounting Solutions

PART NUMBER(S):

242-02070, 242-02071

REVISION:

**A**

595 MARKET STREET, 29TH FLOOR • SAN FRANCISCO, CA 94105 USA  
PHONE (415) 580-6900 • FAX (415) 580-6902

THE INFORMATION IN THIS DRAWING IS CONFIDENTIAL AND PROPRIETARY. ANY REPRODUCTION, DISCLOSURE, OR USE THEREOF IS PROHIBITED WITHOUT THE WRITTEN CONSENT OF SUNRUN SOUTH LLC.

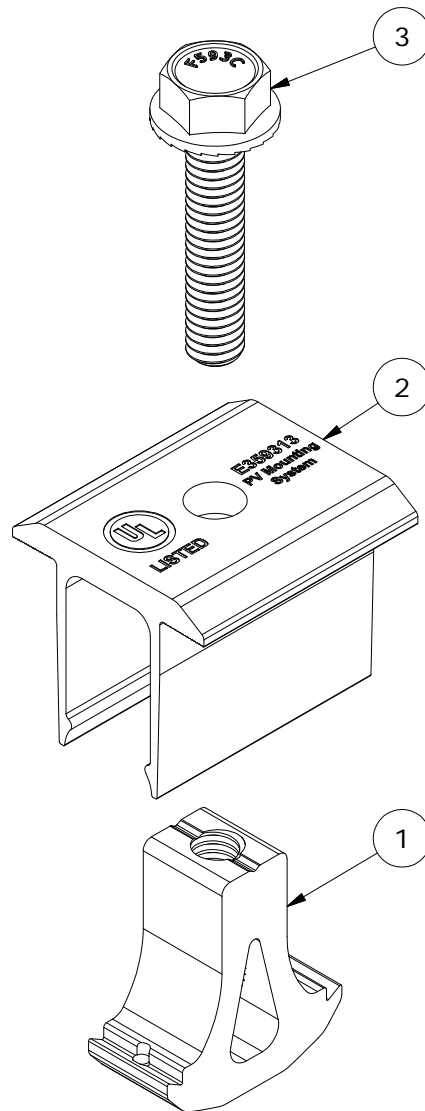
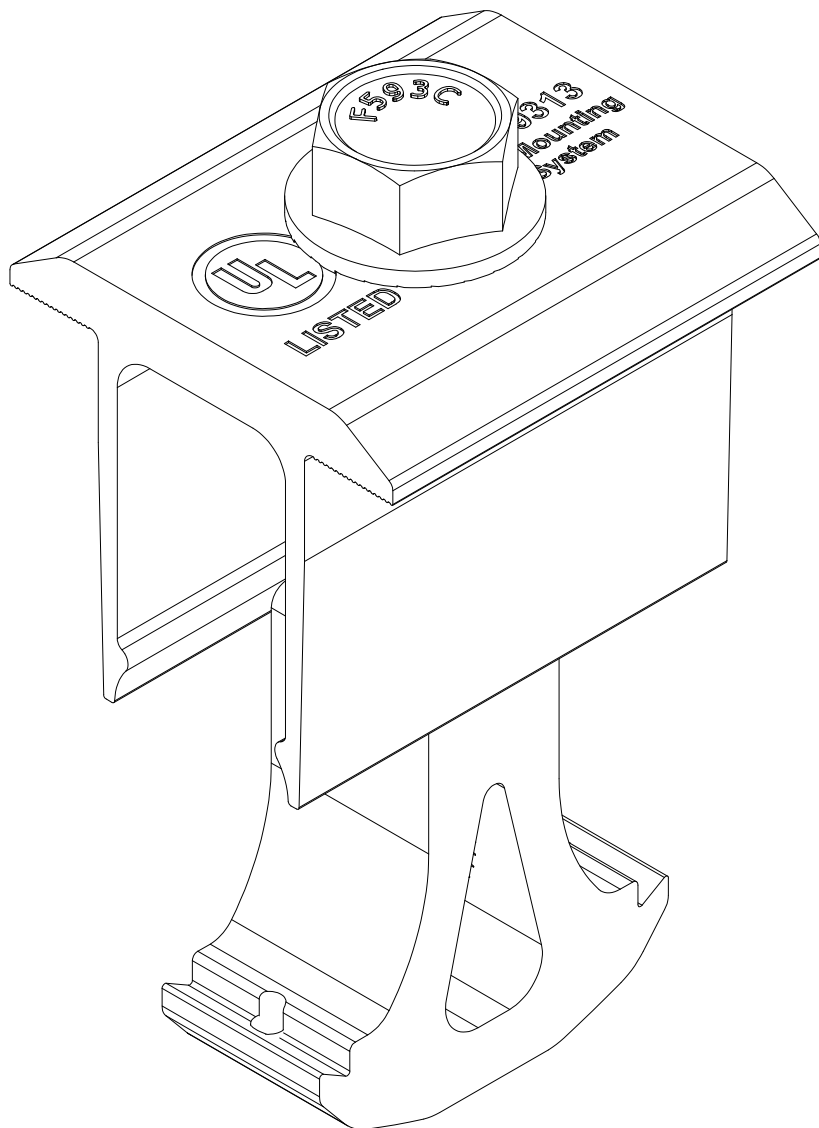

NOTE:  
CLAMPS FIT 30-46MM THICK MODULE FRAMES

PARTS LIST		
ITEM	QTY	DESCRIPTION
1	1	SNAPNRACK, ULTRA RAIL MID CLAMP, BASE
2	1	SNAPNRACK, ULTRA RAIL MID CLAMP, TOP
3	1	BOLT, FLANGE SERRATED, 5/16IN-18 X 1-1/2IN, SS

MATERIALS:	6000 SERIES ALUMINUM, STAINLESS STEEL	OPTIONS:
DESIGN LOAD (LBS):	855	CLEAR / BLACK ANODIZED
ULTIMATE LOAD (LBS):	2823	
TORQUE SPECIFICATION:	16 LB-FT	
CERTIFICATION:	UL 2703, FILE E359313	
WEIGHT (LBS):	0.15	

DESCRIPTION:

SNAPNRACK, ULTRA RAIL MID CLAMP

DRAWN BY:

mwatkins

REVISION:

A

SnapNrack™  
Solar Mounting Solutions

PART NUMBER(S):

242-02070, 242-02071

595 MARKET STREET, 29TH FLOOR • SAN FRANCISCO, CA 94105 USA  
PHONE (415) 580-6900 • FAX (415) 580-6902

THE INFORMATION IN THIS DRAWING IS CONFIDENTIAL AND PROPRIETARY. ANY REPRODUCTION, DISCLOSURE, OR USE THEREOF IS PROHIBITED WITHOUT THE WRITTEN CONSENT OF SUNRUN SOUTH LLC.

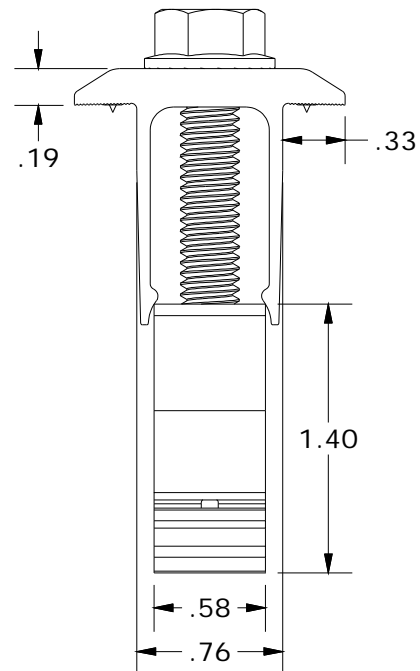
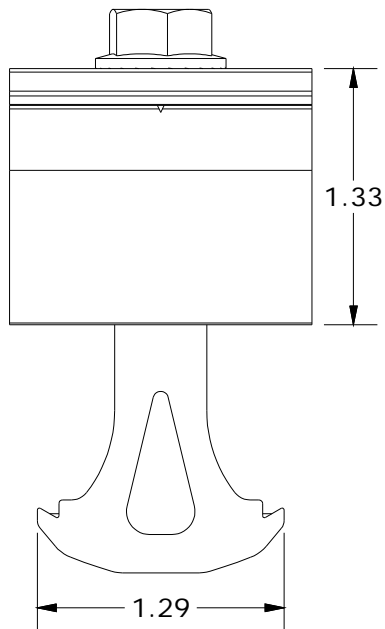
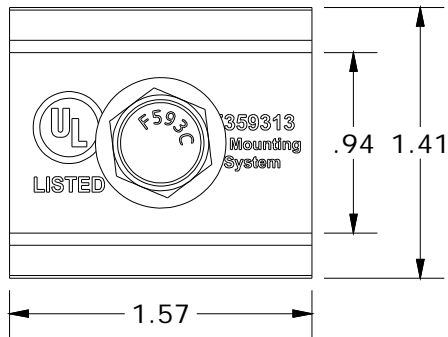

ALL DIMENSIONS IN INCHES